

**Dimensional Layout:**

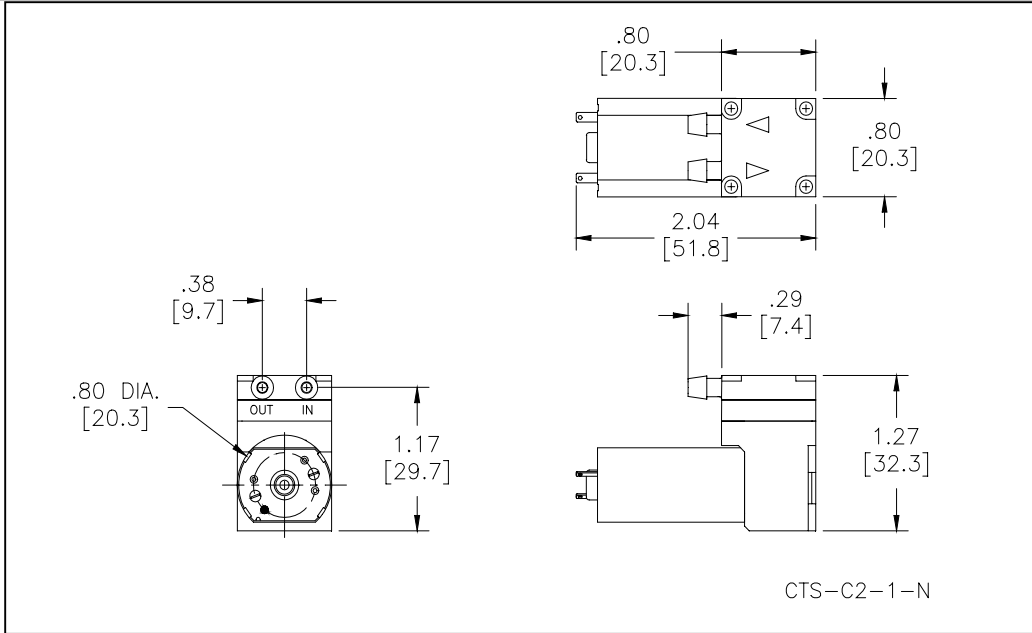

**Specifications:**

<b>1. Wetted Materials:</b>	Pump Head:	Polycarbonate	<b>3. Electrical:</b>	Motor:	Brush Sleeve Bearing
	Retainer Washer:	Polysulfone		Operating Voltage:	12.0 VDC
	Retainer Screw:	18-8 Stainless		In-rush Current:	5 x Operating Current for up to 50 MS
	Valves:	EPDM [65]		Recommended Fusing:	Slow Blow @ 2 x Operating Current
	Diaphragm:	AEPDM [C80]			

<b>2. Performance:</b>	<u>Continuous</u>	<u>Maximum</u>
	- Pressure: PSIG [Air]	28.0

<b>4. Other:</b>	Temperature Range:	5 - 50° C
	Free Flow RPM:	8000
	Eccentric:	E535

**5. Operating Limitations:** Not configured for vacuum operation

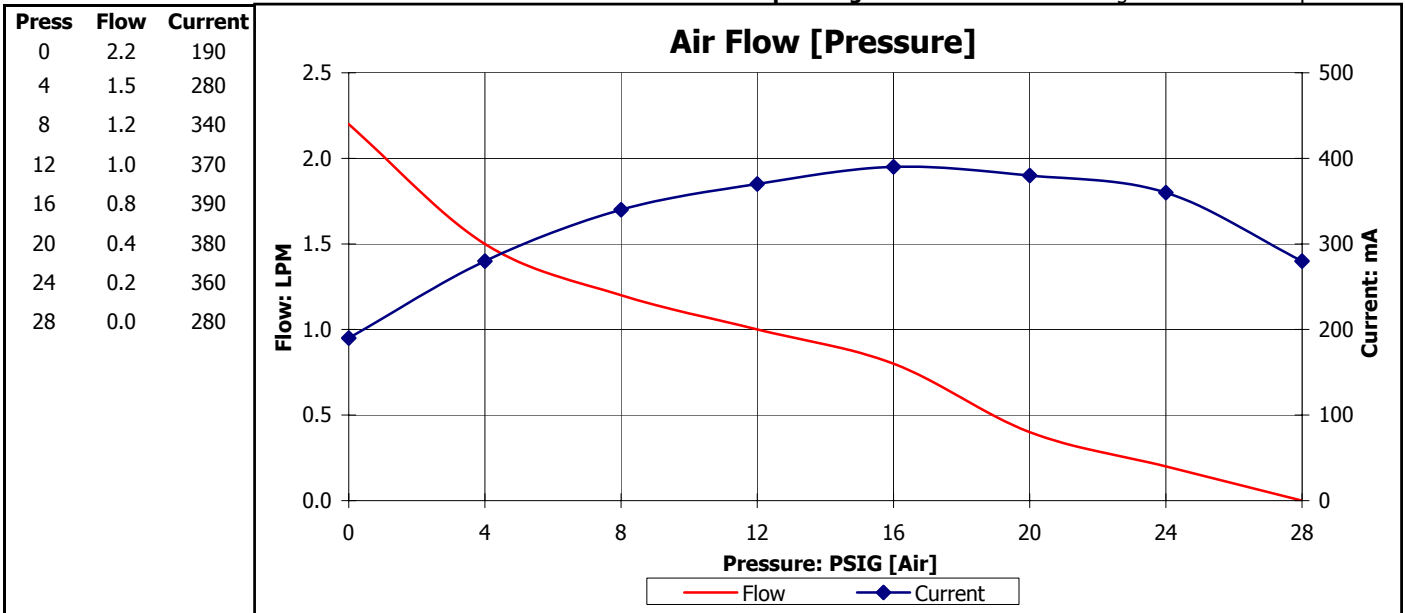

The above graph denotes nominal performance at 800' above sea level, 24°C, and at the specified voltage.

**ST**