

Dimensional Layout:

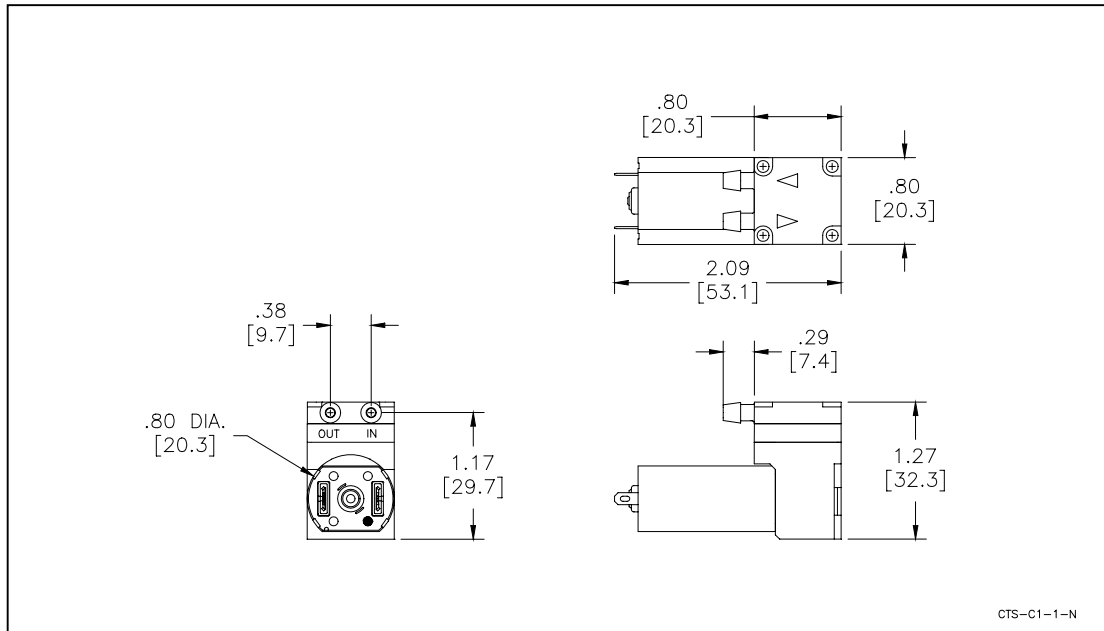

CTS-C1-1-N

Specifications:

- | | | | | | | |
|-----------------------------|------------------------|-------------------|-----------------------|---------------------|---------------------------------------|-----------|
| 1. Wetted Materials: | Pump Head: | Polycarbonate | 3. Electrical: | Motor: | Brush Sleeve Bearing | |
| | Retainer Washer: | Polysulfone | | Operating Voltage: | 9.0 VDC | |
| | Retainer Screw: | 18-8 Stainless | | In-rush Current: | 5 x Operating current for up to 50 ms | |
| | Valves: | EPDM [65] | | Recommended Fusing: | Slow Blow @ 2 x Operating Current | |
| | Diaphragm: | AEPDM [C80] | | | | |
| 2. Performance: | | <u>Continuous</u> | <u>Maximum</u> | 4. Other: | Temperature Range: | 5 - 50° C |
| | - Pressure: PSIG [Air] | 12.0 | 28.0 | | Free Flow RPM: | 8000 |
| | | | | | Eccentric: | E535 |

5. Operating Limitations: Not configured for vacuum operation

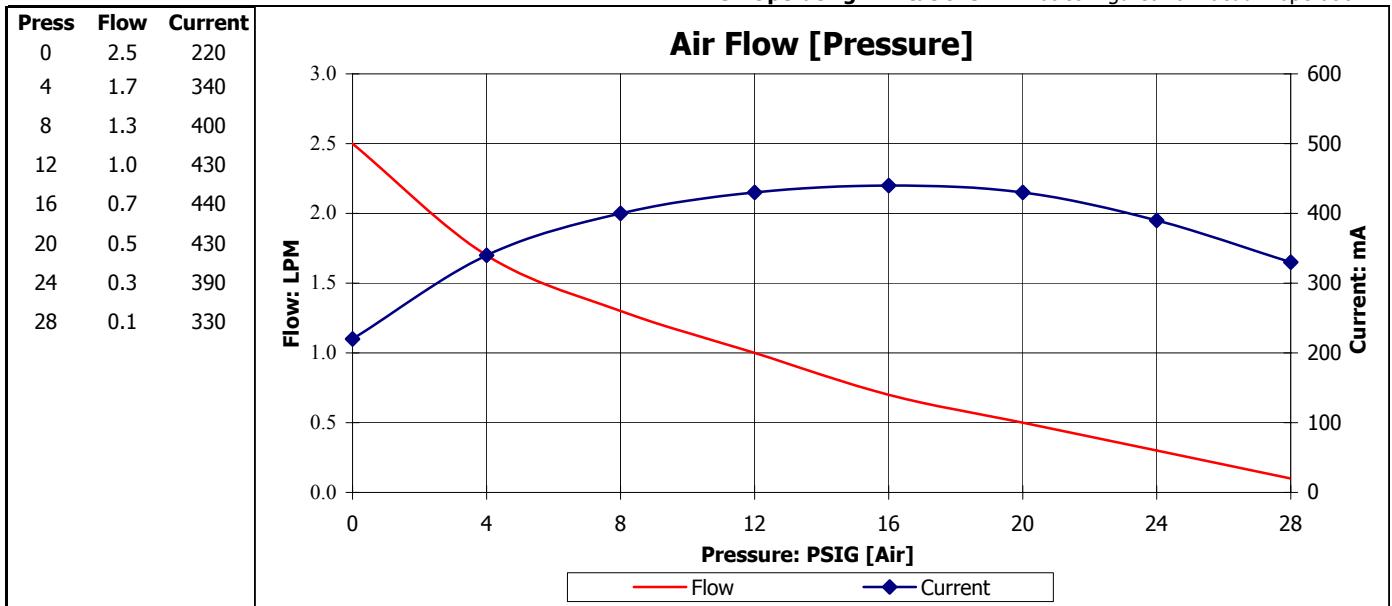

The above graph denotes nominal performance at 800' above sea level, 24°C, and at the specified voltage.

ST